

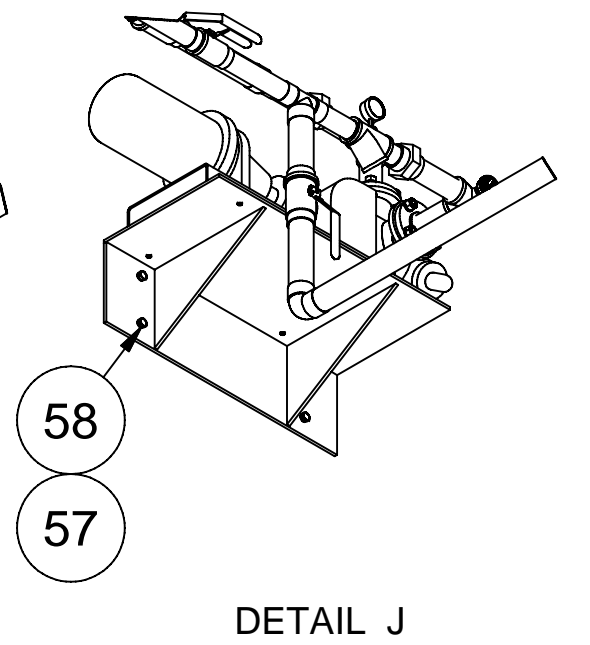

Steward Observatory, University of Arizona
 933 N. Cherry Avenue, Tucson, AZ 85721-0065
 Phone: (520)621-7659 FAX: (520)621-3398

DO NOT SCALE DRAWING INTERPRET DIMENSIONS AND TOLERANCES IN ACCORDANCE WITH ASME Y14.5M-94	THIS DRAWING CREATED IN:				DESIGNED BY:	DATE:	LARGE BINOCULAR TELESCOPE <small>LBT Project Office/USA Steward Observatory, University of Arizona Tucson, AZ 85721-0065 USA Ph. 1 520 626-6231 Fax. 1 520 626-8933</small>
	ACAD	MECH	IDEAS	INV	V. GASHO	05/17/07	
TOLERANCES UNLESS OTHERWISE SPECIFIED LINEAR ANGULAR .X = ± .1 ± 1° .XX = ± .03 .XXX = ± .010 DIAMETRICAL: SEE SPEC S-002 <small>DIMENSIONS ARE IN INCHES / DIMENSIONS IN [] ARE METRIC</small>					DRAWN BY:	DATE:	TELESCOPE AUXILIARIES 580 BALANCING SYSTEM DYNAMIC BALANCING
					V. GASHO	05/17/07	
MATERIAL:					LST REV BY:	DATE:	Z-PIPING SYSTEM ASSY
	TBD	LBT					
FINISH:					CHECKED BY:	DATE:	CAN NO:
	---	ASSEMBLY APPLICATION			J. NOENICKX	05/21/07	
					ACCEPT BY:	DATE:	REVISION:
					V. GASHO	05/21/07	
					RELEASE BY:	DATE:	SHEET 2 OF 4
					J. BRYNNEL	05/21/07	
					APPROVED:	DATE:	580s050
					APPROVED:	DATE:	B

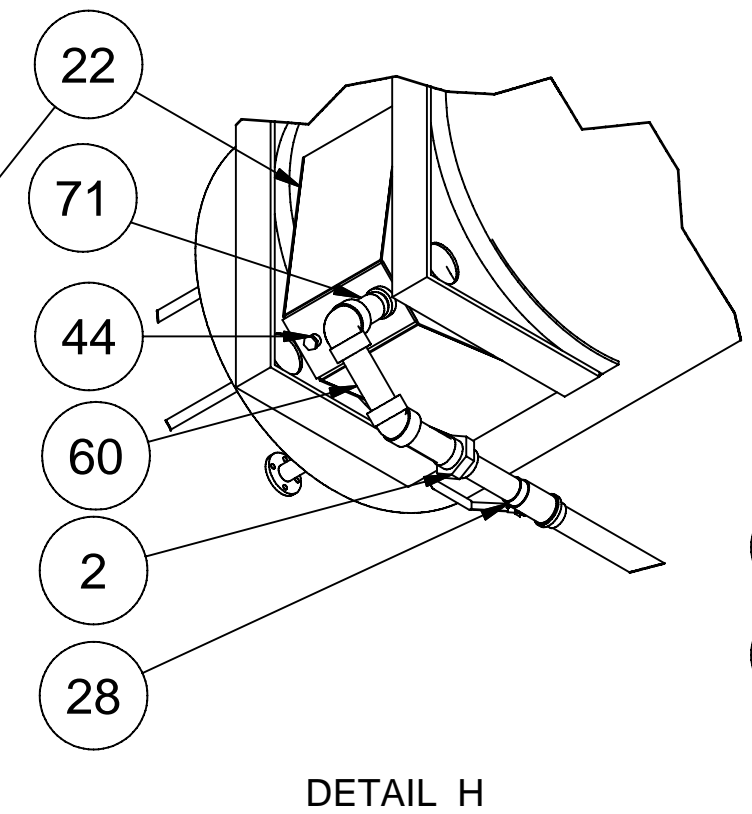
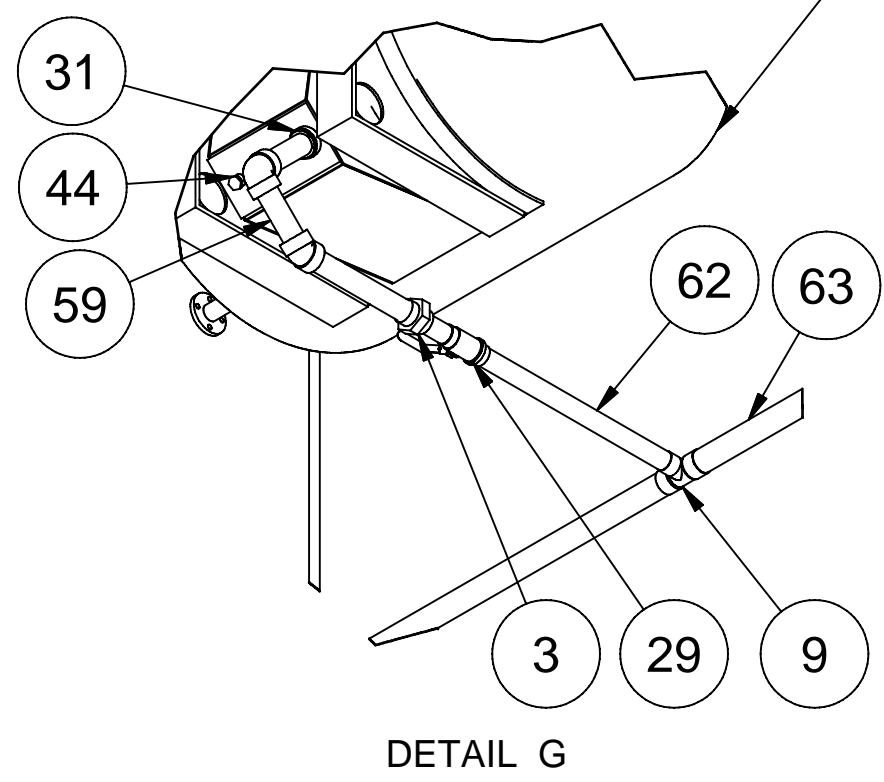
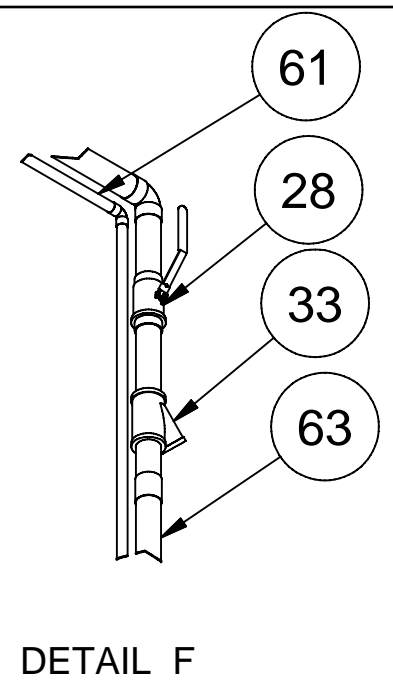
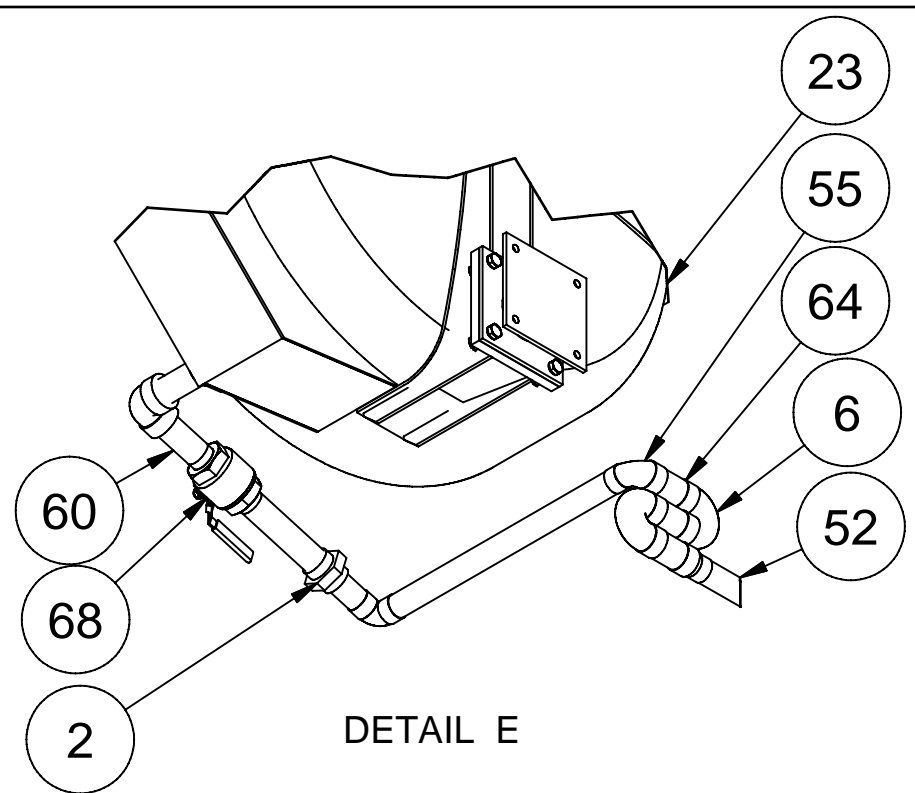
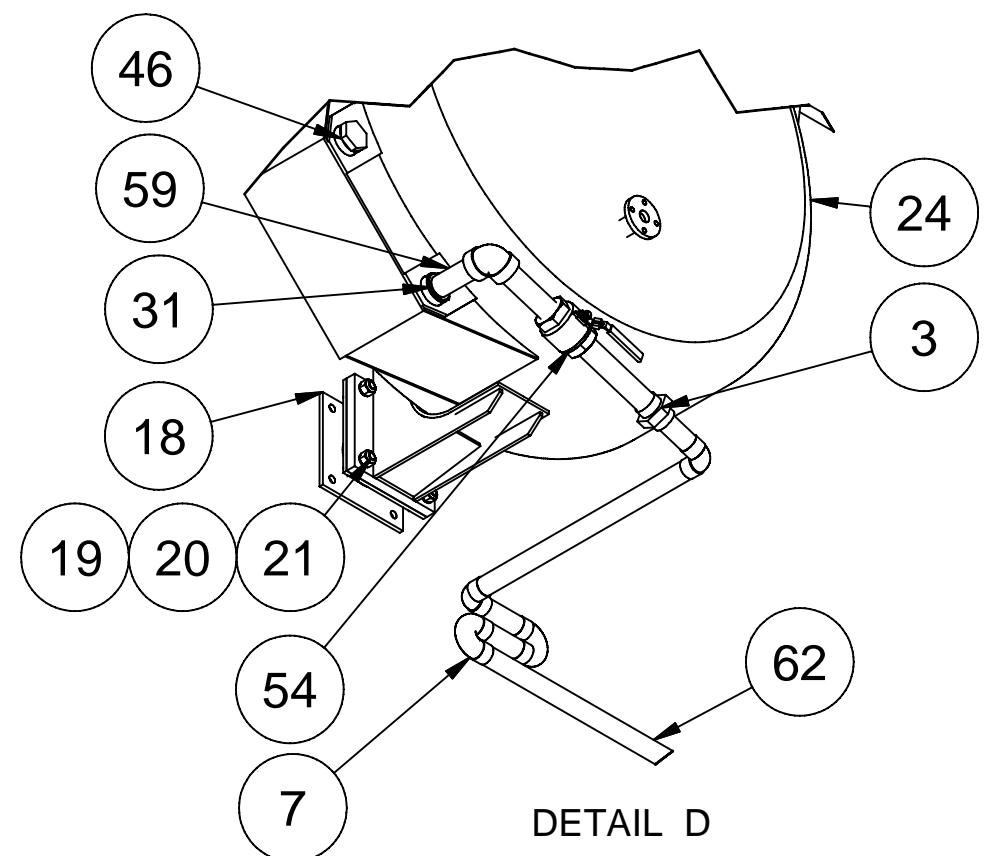
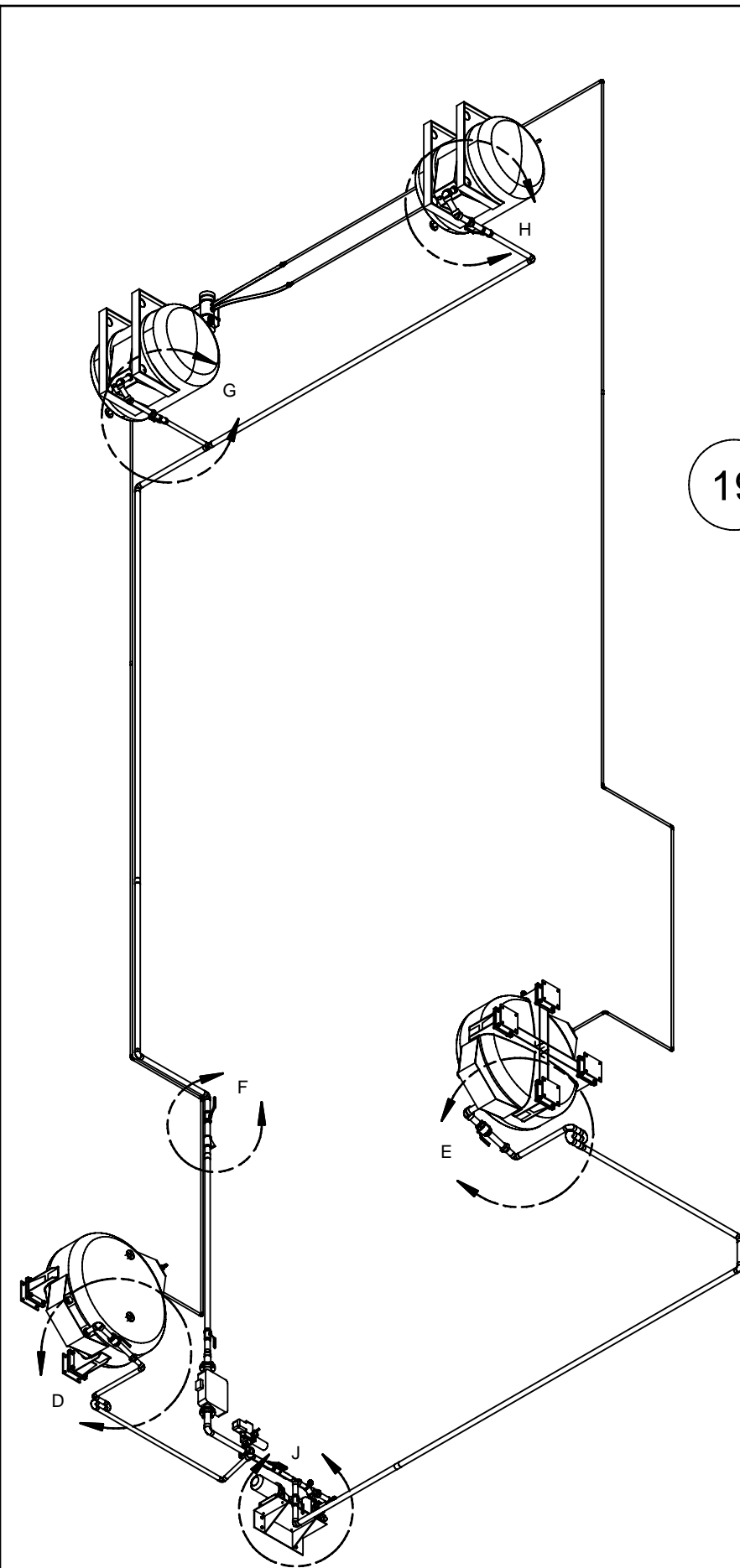
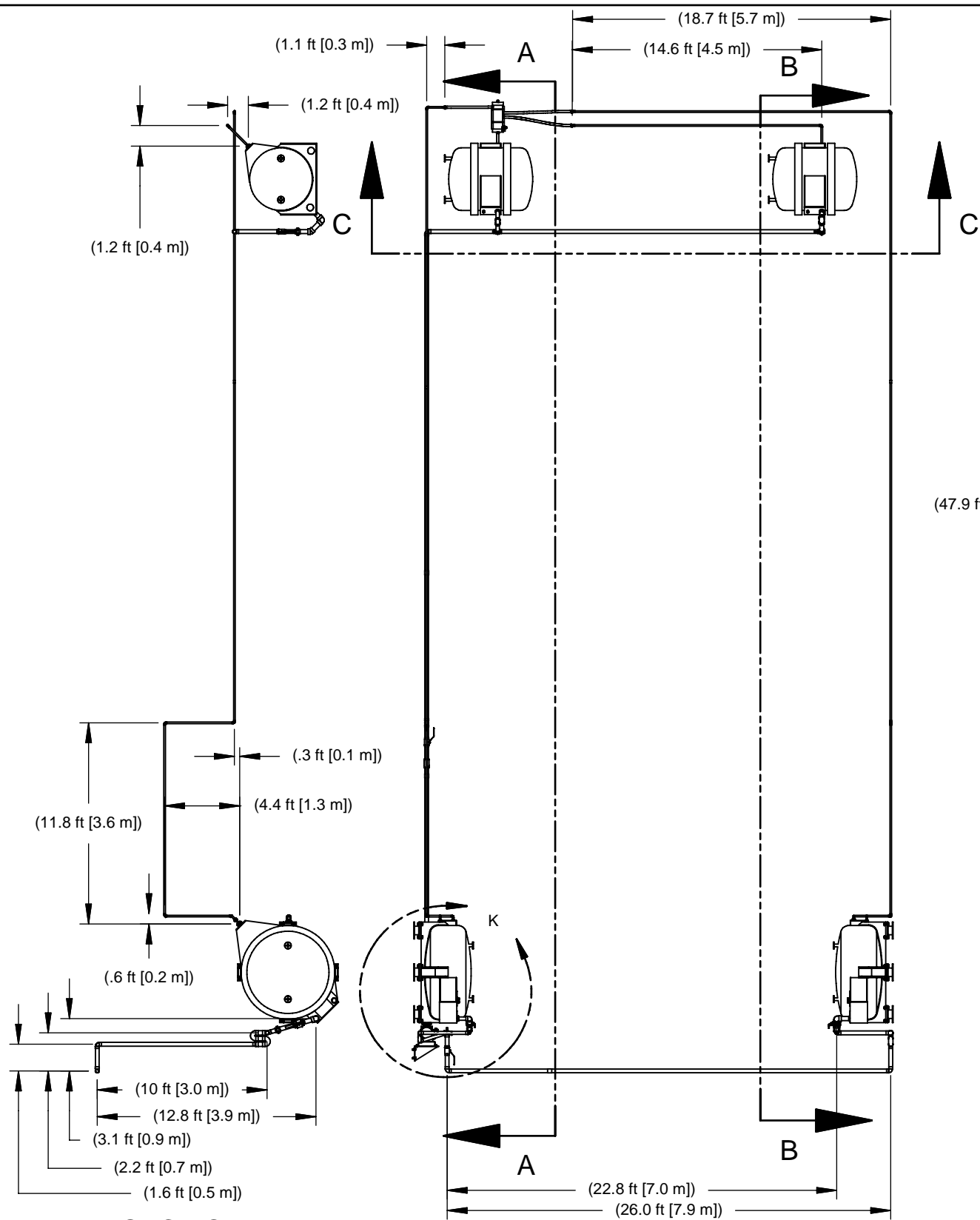

DO NOT SCALE DRAWING INTERPRET DIMENSIONS AND TOLERANCES IN ACCORDANCE WITH ASME Y14.5M-94	THIS DRAWING CREATED IN:				DESIGNED BY:	DATE:	LARGE BINOCULAR TELESCOPE <small>LBT Project Office/USA Steward Observatory, University of Arizona Tucson, AZ 85721-0065 USA Ph. 1 520 626-6231 Fax. 1 520 626-9333</small>
	ACAD	MECH	IDEAS	INV	V. GASHO	05/17/07	
TOLERANCES UNLESS OTHERWISE SPECIFIED LINEAR ANGULAR .X = ± .1 ± 1° .XX = ± .03 .XXX = ± .010 DIAMETRICAL: SEE SPEC S-002 <small>DIMENSIONS ARE IN INCHES / DIMENSIONS IN [] ARE METRIC</small>					DRAWN BY:	DATE:	TELESCOPE AUXILIARIES 580 BALANCING SYSTEM DYNAMIC BALANCING
					V. GASHO	05/17/07	
MATERIAL:					LST REV BY:	DATE:	Z-PIPING SYSTEM ASSY
FINISH:					CHECKED BY:	DATE:	580s050
					J. NOENICKX	05/21/07	
---	ASSEMBLY APPLICATION				ACCEPT BY:	DATE:	SHEET 3 OF 4
					V. GASHO	05/21/07	
					RELEASE BY:	DATE:	REVISION: B
					J. BRYNNEL	05/21/07	
					APPROVED:	DATE:	CAN NO:



SECTION B-B

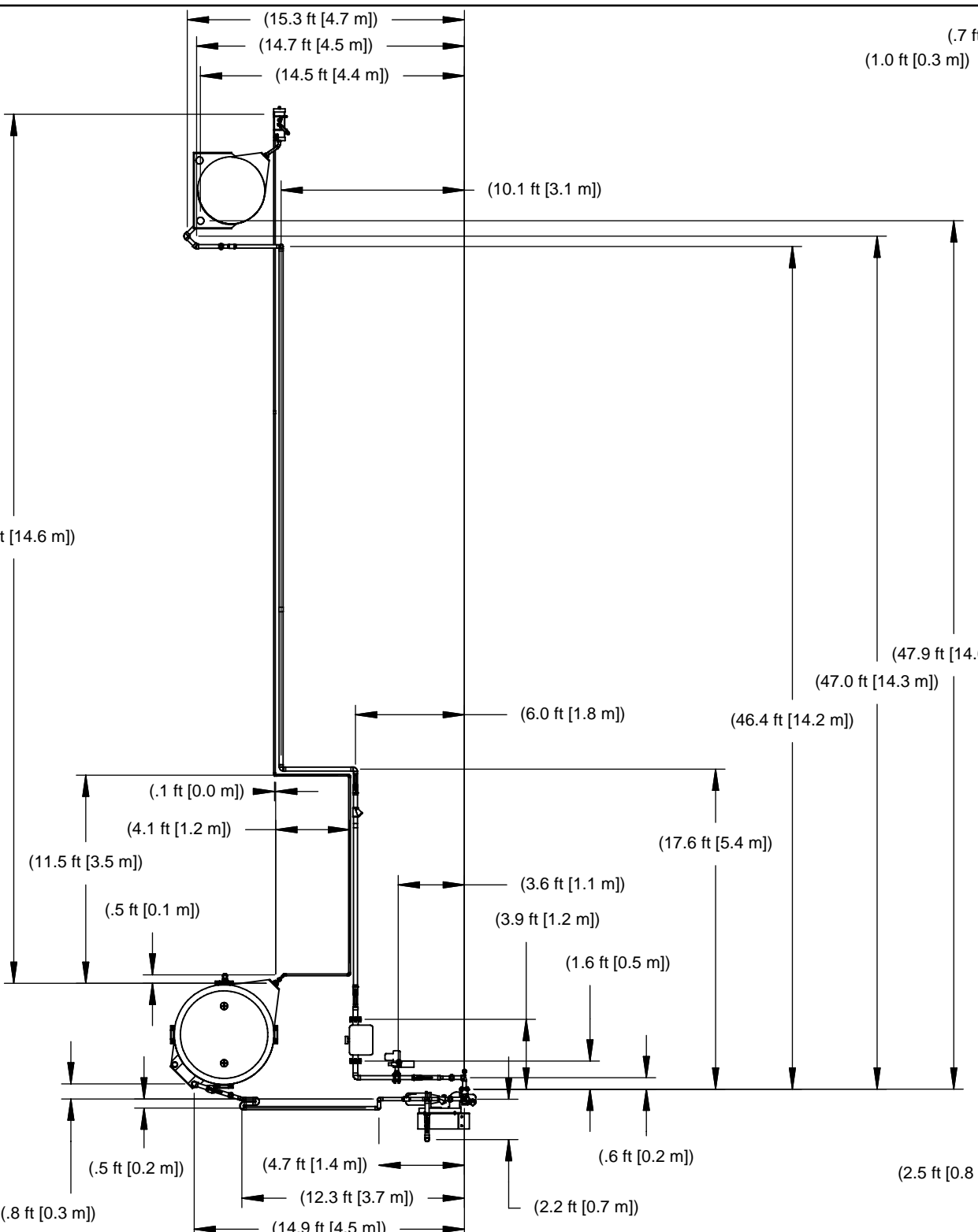

SECTION A-A

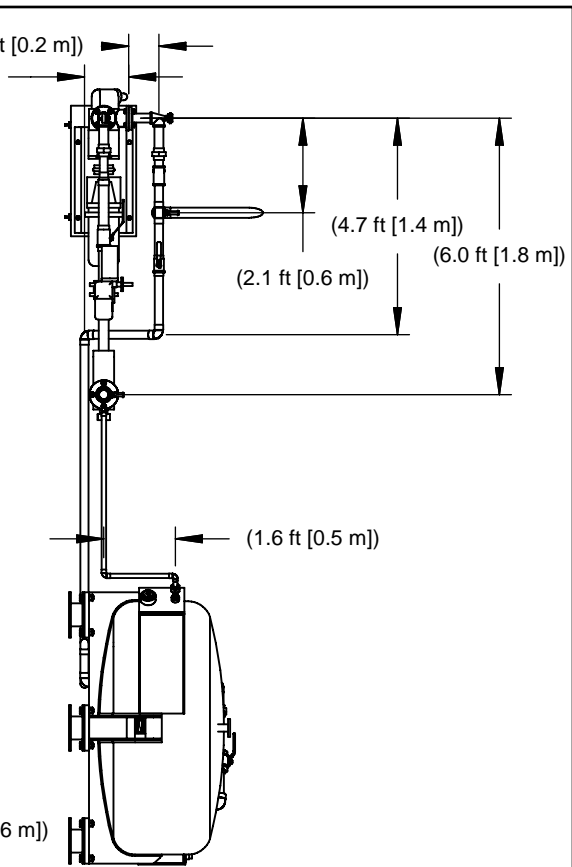

DETAIL K

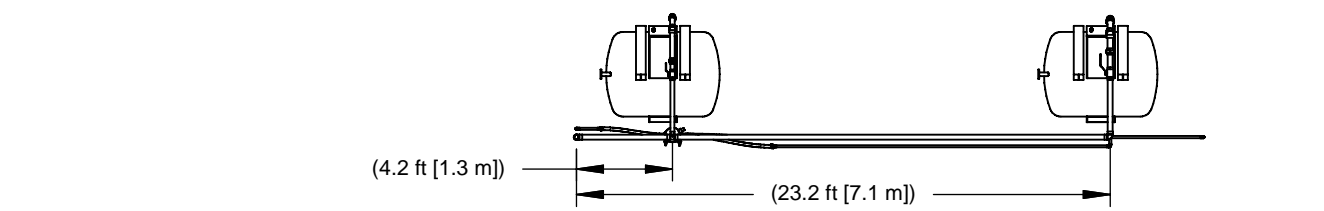

SECTION C-C



Steward Observatory, University of Arizona
 933 N. Cherry Avenue, Tucson, AZ 85721-0065
 Phone: (520)621-7659 FAX: (520)621-3398

DO NOT SCALE DRAWING INTERPRET DIMENSIONS AND TOLERANCES IN ACCORDANCE WITH ASME Y14.5M-94	THIS DRAWING CREATED IN: ACAD <input type="checkbox"/> MECH <input type="checkbox"/> IDEAS <input type="checkbox"/> INV <input checked="" type="checkbox"/>	DESIGNED BY: V. GASHO	DATE: 05/17/07
TOLERANCES UNLESS OTHERWISE SPECIFIED LINEAR .X = ± .1 .XX = ± .03 .XXX = ± .010 ANGULAR ± 1° DIAMETRICAL: SEE SPEC S-002 DIMENSIONS ARE IN INCHES / DIMENSIONS IN [] ARE METRIC		DRAWN BY: V. GASHO	DATE: 05/17/07
MATERIAL: TBD	LBT	CHECKED BY: J. NOENICKX	DATE: 05/21/07
FINISH: ---	ASSEMBLY APPLICATION	ACCEPT BY: V. GASHO	DATE: 05/21/07
		RELEASE BY: J. BRYNNEL	DATE: 05/21/07
		APPROVED:	DATE:
		APPROVED:	DATE:

LARGE BINOCULAR TELESCOPE	
LBT Project Office/USA Steward Observatory, University of Arizona Tucson, AZ 85721-0065 USA Ph. 1 520 626-6231 Fax. 1 520 626-9333	
TELESCOPE AUXILIARIES	
580 BALANCING SYSTEM	
DYNAMIC BALANCING	
Z-PIPING SYSTEM ASSY	
CAN NO:	REVISION:
580s050	B